



Helena Airports District Office  
2725 Skyway Drive, Suite 2  
Helena, Montana 59602  
Phone: (406) 449-5271  
Fax: (406) 449-5274

December 21, 2023

Skip Brandt, Chairman  
Idaho County Commission  
320 W. Main St.  
Grangeville, ID 83530

Dear Chairman Brandt:

The Airport Layout Plan (ALP) for Idaho County Airport (GIC), Grangeville, Idaho prepared by J-U-B Engineers and bearing your signature, is conditionally approved. Please digitally embed this letter onto the signed ALP and distribute accordingly.

An aeronautical study (no. 2023-ANM-5074-NRA) was conducted on the proposed development. This determination does not constitute FAA approval or disapproval of the physical development involved in the proposal. It is a determination with respect of the safe and efficient use of navigable airspace by aircraft and with respect to the safety of persons and property on the ground.

In making this determination, the FAA has considered matters such as the effects the proposal would have on existing or planned traffic patterns of neighboring airports, the effects it would have on the existing airspace structure and projected programs of the FAA, the effects it would have on the safety of persons and property on the ground, and the effects that existing or proposed manmade objects (on file with the FAA), and known natural objects within the affected areas would have on the airport proposal.

The FAA has only limited means to prevent the construction of structures near an airport. The airport sponsor has the primary responsibility to protect the airport environs through such means as local zoning ordinance, property acquisition, aviation easements, letters of agreement, or other means.

This ALP approval is conditioned on the acknowledgement that any development on airport property that results in a change to the ALP requiring Federal approval, or that will receive federal funding, is subject to the National Environmental Policy Act of 1969 (NEPA). Therefore, the sponsor must receive such written approval from FAA prior to commencement of the subject development. Prior to any development on the airport, coordination with the ADO is required to ensure that all environmental requirements are met. Early coordination is critical to ensure that project schedules as well as NEPA compliance can be met. This ALP approval is also conditioned on acceptance of the plan under local land use laws. We encourage appropriate agencies to adopt land use and height restrictive zoning based on the plan.

2

# AIRPORT LAYOUT PLAN IDAHO COUNTY AIRPORT (GIC)

## GRANGEVILLE, IDAHO COUNTY, IDAHO

DECEMBER 2023

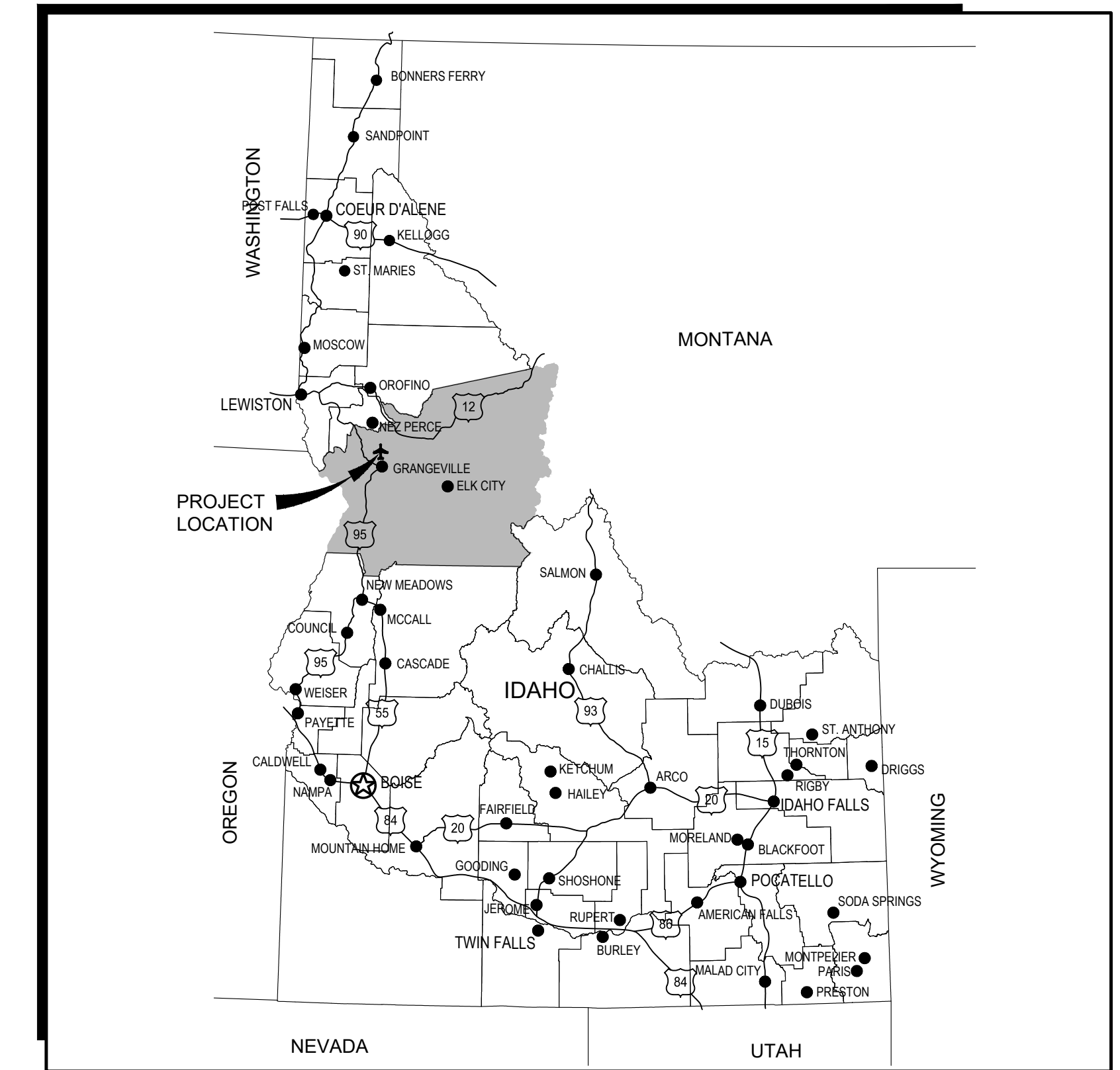

AREA MAP

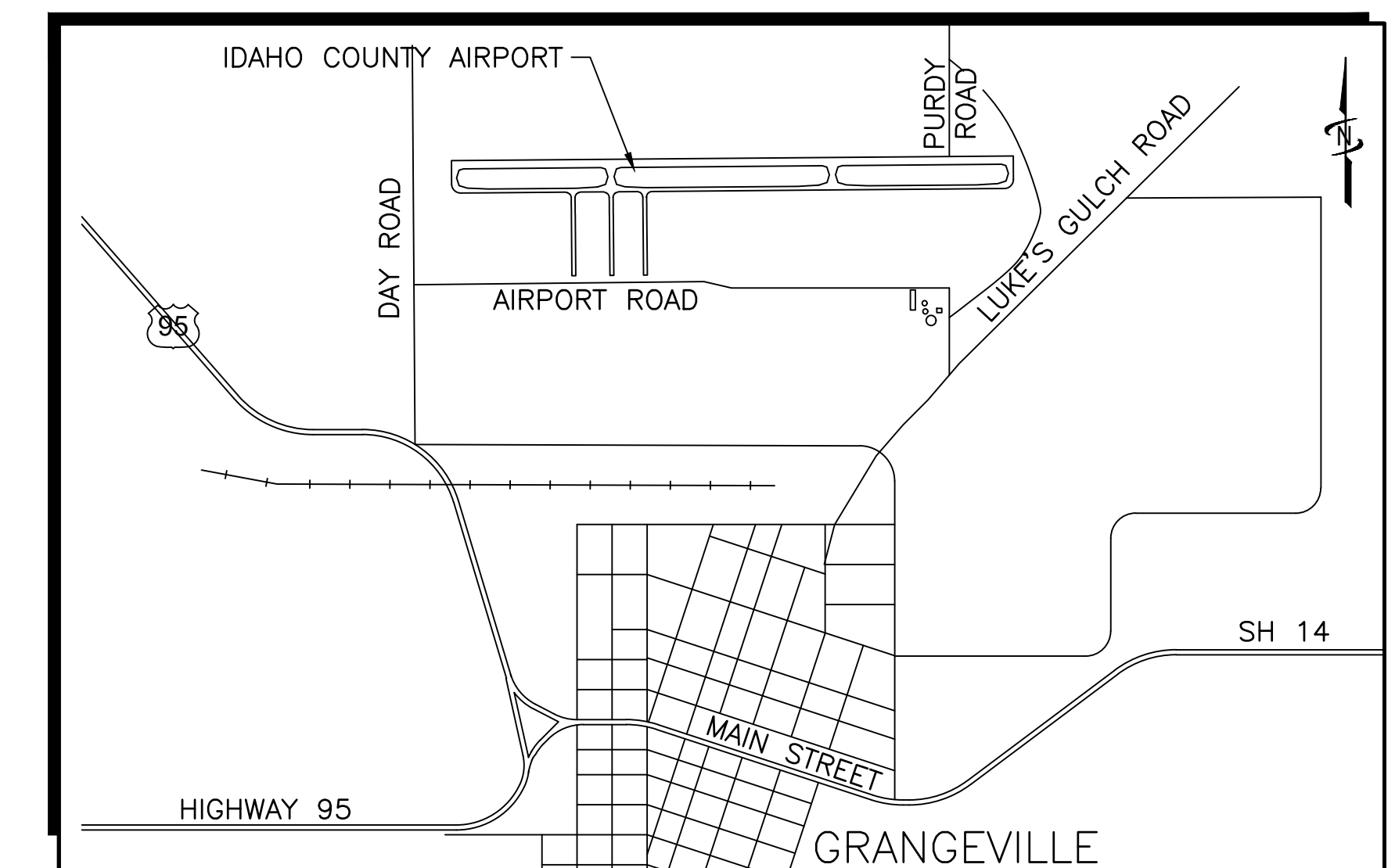

VICINITY MAP

Approval of the plan does not indicate that the United States will participate in the cost of any development proposed. AIP funding requires evidence of eligibility and justification at the time a funding request is ripe for consideration. When construction of any proposed structure or development indicated on the plan is undertaken, such construction requires normal 45-day advance notification to FAA for review in accordance with applicable Federal Aviation Regulations (i.e., Parts 77, 157, 152, etc.). More notice is generally beneficial to ensure that all statutory, regulatory, technical and operational issues can be addressed in a timely manner.

We are enclosing one copy of the approved ALP drawing set for your records. Please attach this letter to the Airport Layout Plan and retain it at the airport. If you have any questions, please contact Jared Wingo in our office at 406-441-5233.

Sincerely,

 Digitally signed by JARED LEE WINGO  
Date: 2023.12.21 13:55:00 -0700

Jared Wingo, Airport Planner  
Helena Airports District Office

Enclosure

cc: Kayla Brown, P.E., J-U-B Engineers, Inc.  
Jennifer Schildgen, Idaho Division of Aeronautics

AIP NO. 3-16-0015-020-2021

846 6th Street  
Clarkston, WA 99403  
p 509-254-6011 w www.jub.com



J-U-B ENGINEERS, INC.



THE LANGDON GROUP



GATEWAY MAPPING INC.

J-U-B FAMILY OF COMPANIES

OWNER  
IDAHO COUNTY

IDAHO COUNTY COMMISSIONERS:  
SKIP BRANDT, CHAIRMAN  
TED LINDSLEY  
DENIS DUMAN

AIRPORT MANAGER  
MIKE COOK

INDEX OF SHEETS		
NUMBER	SHEET TITLE	REVISION DATE
AF-1	TITLE SHEET	
AF-2	AIRPORT LAYOUT PLAN	
AF-3	AIRPORT DATA SHEET	
AF-4	AIRPORT AIRSPACE PLAN - FROM PRIOR ALP	
AF-5	INNER APPROACH DRAWING - FROM PRIOR ALP	
AF-6	TERMINAL AREA PLAN - WEST APRON AREA	
AF-7	TERMINAL AREA PLAN - EAST APRON AREA	
AF-8	LAND USE PLAN	
AF-9	EXHIBIT A - AIRPORT PROPERTY INVENTORY MAP	

REUSE OF DRAWINGS  
THIS DOCUMENT, AND THE IDEAS AND DESIGNS INCORPORATED HEREIN, AS AN INSTRUMENT OF PROFESSIONAL SERVICE, IS THE PROPERTY OF J-U-B ENGINEERS, INC. AND IS NOT TO BE USED, IN WHOLE OR PART, FOR ANY OTHER PROJECT WITHOUT THE EXPRESS WRITTEN AUTHORIZATION OF J-U-B ENGINEERS, INC.

REVISION			
NO.	DESCRIPTION	FAA UPDATE (APR)	DATE

LAST UPDATED: September 7, 2023

SHEET NUMBER:

AF-1



AIRPORT DATA TABLE		
ITEM	EXISTING	FUTURE/ULTIMATE
AIRPORT REFERENCE CODE (ARC)	B-II	B-II
MEAN MAXIMUM TEMPERATURE	AUGUST 82.5°F	
AIRPORT ELEVATION (ABOVE MSL)	3313.05	3313.05
AIRPORT NAVIGATIONAL AIDS	BEACON, LIGHTED WIND CONE	BEACON, LIGHTED WIND CONE
AIRPORT REFERENCE POINT	N45°56'33.58", W116°07'22.95"	N45°56'33.58", W116°07'22.95"
MISCELLANEOUS FACILITIES	SEG CIRCLE, AWOS	SEG CIRCLE, AWOS
CRITICAL AIRCRAFT	CESSNA CITATION V	CESSNA CITATION V
MAGNETIC DECLINATION, RATE OF CHANGE*	13°28'E, 0° 06' W / 2020 (NOAA)	
NPIAS SERVICE LEVEL	LOCAL	LOCAL
STATE EQUIVALENT SERVICE LEVEL (2020)	GA (ASP)	GA (ASP)

\*DECLINATION BASED ON WORLD MAGNETIC MODEL 2020

AIRPORT FACILITIES LIST		
NAVIGATIONAL AID	OWNERSHIP	
AIRPORT BEACON	IDAHO COUNTY	
LIGHTED WIND CONE AND SEGMENTED CIRCLE	IDAHO COUNTY	
AWOS-3P	IDAHO COUNTY	
MIRL	IDAHO COUNTY	
BEACON	IDAHO COUNTY	
REILS (RWY 8)	FAA	

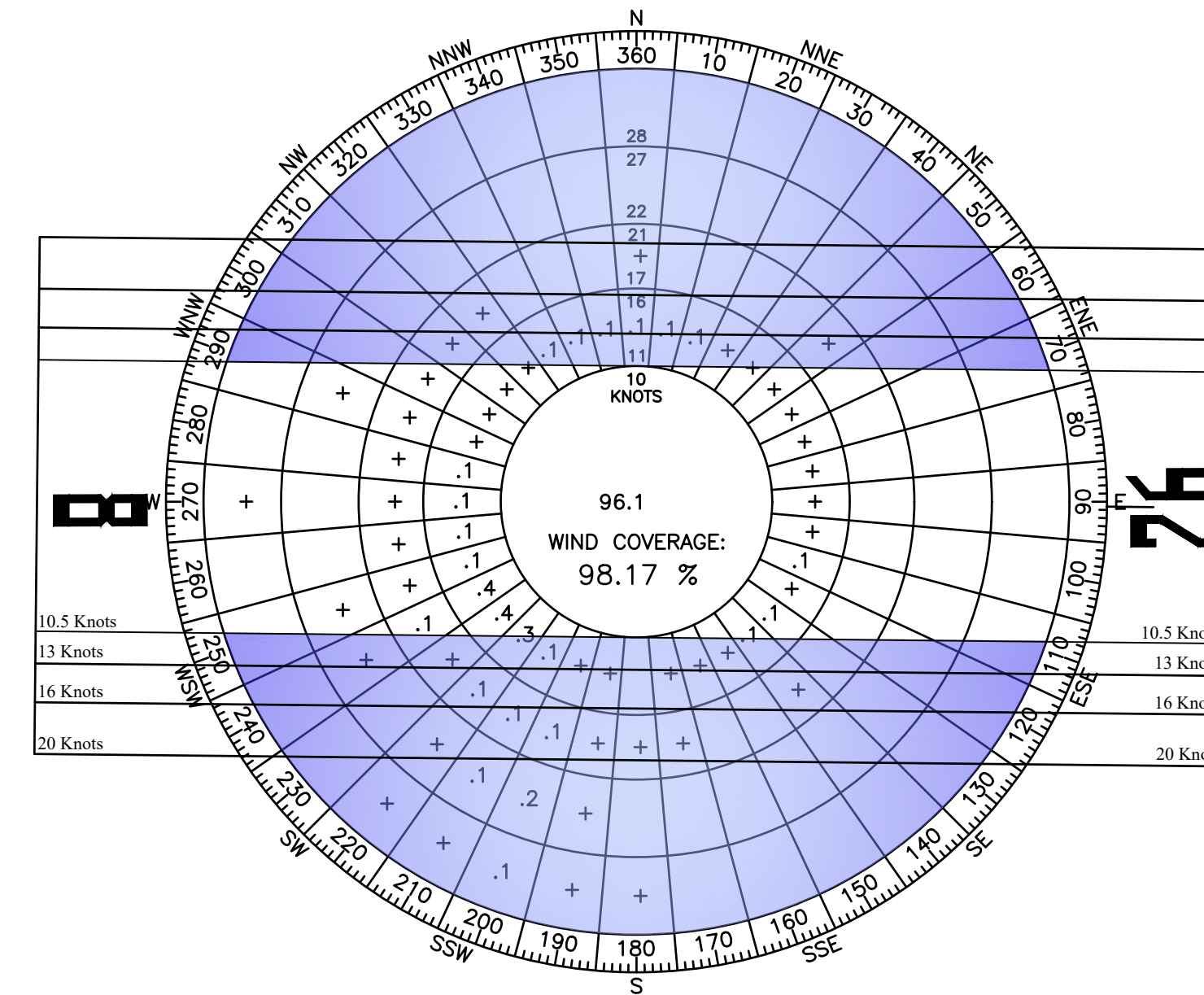

IFR WIND COVERAGE				
RUNWAY	10.5KT	13KT	16KT	20KT
8/26	98.17%	98.85%	99.32%	99.54%

**IFR Wind Rose**  
 Source: NOAA's Integrated Surface Database  
 Station: Idaho County Airport  
 Period: 2011 - 2020  
 Number of Observations: 5,027

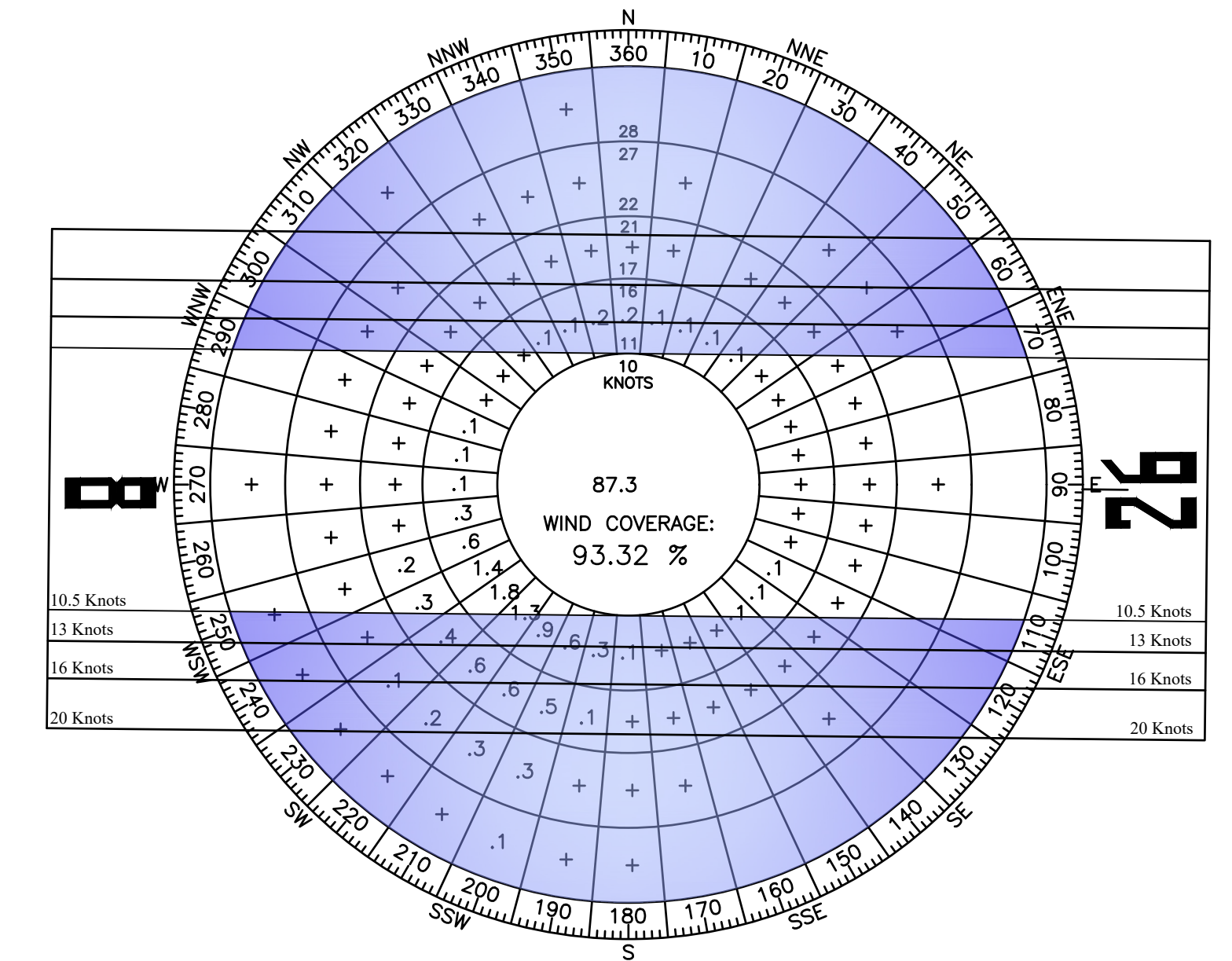

VFR WIND COVERAGE				
RUNWAY	10.5KT	13KT	16KT	20KT
8/26	93.32%	95.84%	97.92%	99.23%

**VFR Wind Rose**  
 Source: NOAA's Integrated Surface Database  
 Station: Idaho County Airport  
 Period: 2011 - 2020  
 Number of Observations: 72,842

RUNWAY DATA TABLE				
ITEM	EXISTING		FUTURE/ULTIMATE	
	RUNWAY 8	RUNWAY 26	RUNWAY 8	RUNWAY 26
RUNWAY IDENTIFICATION	NON-UTILITY (LARGE)			
RUNWAY DESIGN CODE (RDC)	B-II-5000	B-II-5000	B-II-5000	B-II-5000
RUNWAY APPROACH AND DEPARTURE REFERENCE CODE (APRC-DPRC)	B/II/4000 - B/II	B/II/4000 - B/II	B/II/4000 - B/II	B/II/4000 - B/II
RUNWAY SURFACE TYPE	ASPHALT		ASPHALT	
PAVEMENT STRENGTH (SINGLE WHEEL GEAR-S) (DUAL WHEEL GEAR-D)	75,000 (S)		75,000 (S)	
PAVEMENT CLASSIFICATION RATING (PCR)	327/F/D/X/T	327/F/D/X/T	N/A	N/A
SURFACE TREATMENT	NONE		NONE	
EFFECTIVE / MAX. LONG. GRADIENT	0.46% / 0.95% (LOS MET)		0.46% / 0.95% (LOS MET)	
PERCENT WIND COVERAGE (8-26)	93.62% (10.5 KTS), 96.03% (13KTS)			
RUNWAY DIMENSIONS (ACTUAL*)	5,100' X 75'		5,100' X 75'	
DISPLACED THRESHOLD	NO	NO	NO	NO
RUNWAY SAFETY AREA (RSA) WIDTH	150'	150'	150'	150'
RSA BEYOND DEPARTURE END	300'	300'	300'	300'
RUNWAY END COORDINATES	LAT: N45°56'33.87" LONG: W116°07'58.96" EL: 3286.95	LAT: N45°56'33.34" LONG: W116°06'46.79" EL: 3310.35	LAT: N45°56'33.87" LONG: W116°07'58.96" EL: 3286.95	LAT: N45°56'33.34" LONG: W116°06'46.79" EL: 3310.35
RUNWAY LIGHTING TYPE	MIRL		MIRL	
RUNWAY PROTECTION ZONE (RPZ) (APPROACH)	500'x700'x1,000'	500'x700'x1,000'	500'x700'x1,000'	500'x700'x1,000'
RUNWAY PROTECTION ZONE (RPZ) (DEPARTURE)	500'x700'x1,000'	500'x700'x1,000'	500'x700'x1,000'	500'x700'x1,000'
RUNWAY MARKINGS	NON-PRECISION	NON-PRECISION	NON-PRECISION	NON-PRECISION
FAR PART 77 APPROACH CATEGORY	34:1	34:1	34:1	34:1
FAR PART 77 APPROACH TYPE	NON-PRECISION	NON-PRECISION	NON-PRECISION	NON-PRECISION
VISIBILITY MINIMUMS	≥1-MILE	≥1-MILE	≥1-MILE	≥1-MILE
SURVEY REQ'D FOR APPROACH	NOT VERT. GUIDED	NOT VERT. GUIDED	NOT VERT. GUIDED	NOT VERT. GUIDED
RUNWAY DEPARTURE SURFACE	1,000'x6,466'x10,200'	1,000'x6,466'x10,200'	1,000'x6,466'x10,200'	1,000'x6,466'x10,200'
RUNWAY OBJECT FREE AREA (ROFA) WIDTH	500'	500'	500'	500'
ROFA LENGTH BEYOND RWY END/PRIOR TO THRESHOLD	300'	300'	300'	300'
OBSTACLE FREE ZONE (OFZ) WIDTH/LENGTH	400'/200'	400'/200'	400'/200'	400'/200'
THRESHOLD SITING SURFACE (TSS)	TABLE 3-2 ROW 1-4, 7 NO TSS PENETRATIONS	TABLE 3-2 ROW 1-4, 7 NO TSS PENETRATIONS	TABLE 3-2 ROW 1-4, 7 NO TSS PENETRATIONS	TABLE 3-2 ROW 1-4, 7 NO TSS PENETRATIONS
VISUAL / INSTRUMENT NAV AIDS	REILS	NONE	PAPI, REILS	PAPI, REILS
TOUCHDOWN ZONE ELEVATION (TDZ)	3305	3313	3305	3313

\* ACTUAL DISTANCE IS SURVEYED RUNWAY END TO RUNWAY END BASED ON NAD83

**DATUM**  
 VERTICAL DATUM: NAVD88  
 HORIZONTAL DATUM: NAD83

TAXIWAY AND TAXILANE INFO		
ITEM	EXISTING	FUTURE/ULTIMATE
	(ADG-II, TDG-2)	(ADG-II, TDG-2)
TAXIWAY A WIDTH	35'	35'
TAXILANE WIDTH	35'	25'
TAXIWAY SAFETY AREAS (TSA)	79'	79'
TAXIWAY OBJECT FREE AREA (TOFA)	131'	131'
TAXILANE OBJECT FREE AREA (TOFA)	115'	115'
TAXIWAY CENTERLINE TO OBJECT (OBJECTS)	65.5'	65.5'
TAXILANE CENTERLINE TO OBJECT (OBJECTS)	57.5'	57.5'
TAXIWAY LIGHTING	MITU/REFLECTORS*	MITU/REFLECTORS*
TAXILANE LIGHTING	NONE	NONE

\* TAXIWAY LIGHTS INSTALLED AROUND EACH CONNECTOR RADIUS TO MAIN PARALLEL, THEN REFLECTORS INSTALLED.

MODIFICATIONS TO STANDARDS	
RUNWAY 8	RUNWAY 26
NONE REQUIRED	

DECLARED DISTANCES TABLE				
	RUNWAY 8 EXISTING	RUNWAY 26 EXISTING	RUNWAY 8 FUTURE/ULTIMATE	RUNWAY 26 FUTURE/ULTIMATE
TAKEOFF RUNWAY AVAILABLE (TORA)	5,100'	5,100'	5,100'	5,100'
TAKEOFF DISTANCE AVAILABLE (TODA)	5,100'	5,100'	5,100'	5,100'
ACCELERATE STOP DISTANCE AVAILABLE (ASDA)	5,100'	5,100'	5,100'	5,100'
LANDING DISTANCE AVAILABLE (LDA)	5,100'	5,100'	5,100'	5,100'

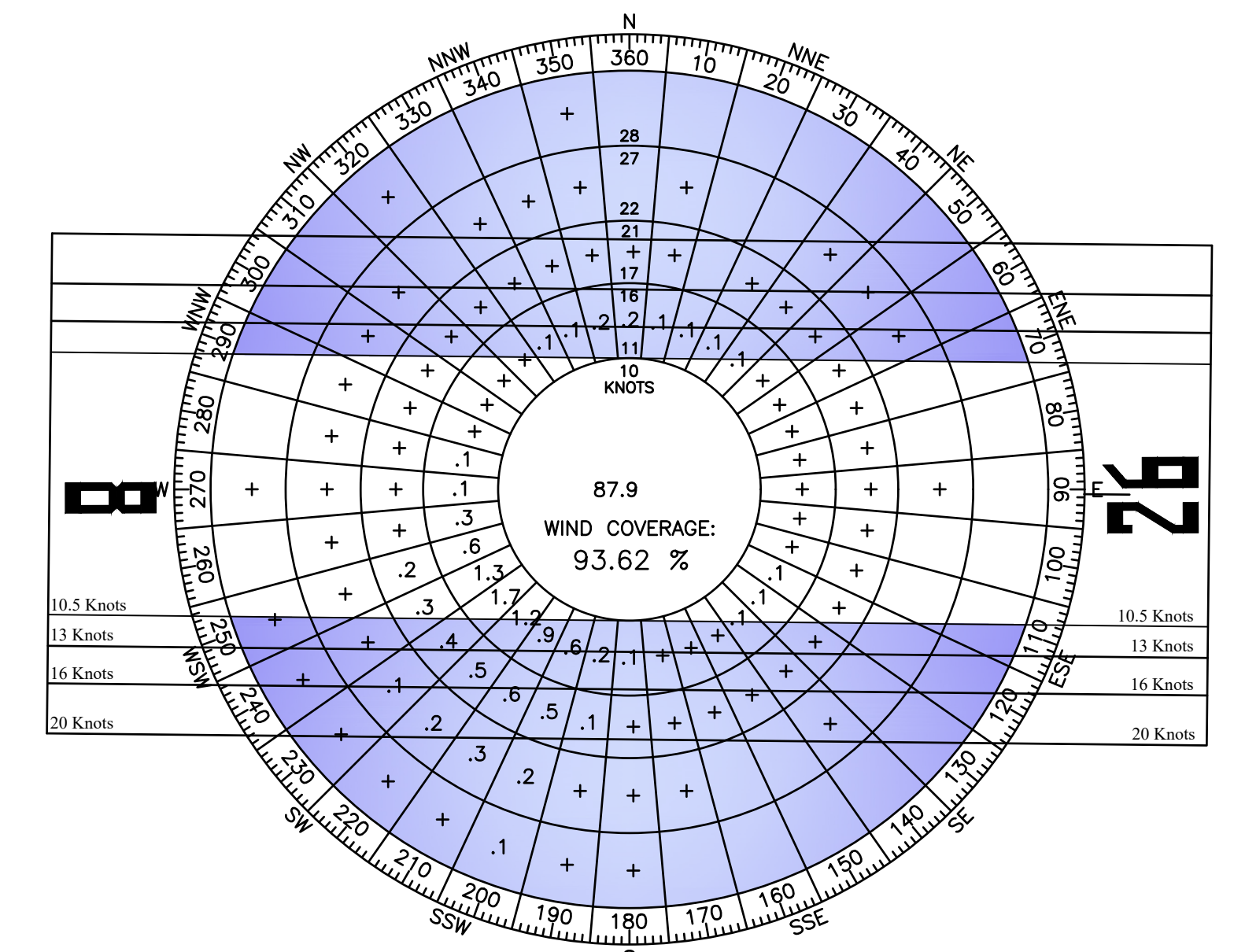

ALL-WEATHER WIND COVERAGE				
RUNWAY	10.5KT	13KT	16KT	20KT
8/26	93.62%	96.03%	98.01%	99.25%

**All-Weather Wind Rose**  
 Source: NOAA's Integrated Surface Database  
 Station: Idaho County Airport  
 Period: 2011 - 2020  
 Number of Observations: 78,611

**REUSE OF DRAWINGS**  
 J-U-B SHALL RETAIN ALL COMMON LAW, STATUTORY, COPYRIGHT AND OTHER RESERVED RIGHTS OF THESE DRAWINGS, AND THE SAME SHALL NOT BE REUSED WITHOUT J-U-B'S PRIOR WRITTEN CONSENT. ANY REUSE WITHOUT WRITTEN CONSENT BY J-U-B WILL BE AT CLIENT'S SOLE RISK AND WITHOUT LIABILITY OR LEGAL EXPOSURE TO J-U-B.

REVISION			
NO.	DESCRIPTION	FAA UPDATE	DATE

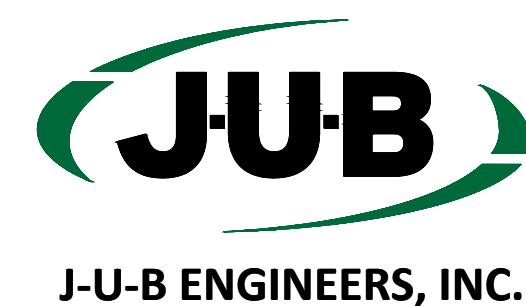

**J-U-B ENGINEERS, INC.**  
 846 6th Street  
 Clarkston, WA 99403  
 Phone: 509-254-6011  
 www.jub.com

FILE: 45-20-020\_AF-3  
 JUB PROJ #: 45-20-020  
 DRAWN BY: SMD  
 DESIGN BY: SMD  
 CHECKED BY: TJE

ONE INCH  
 AT FULL SIZE, IF NOT ONE INCH, SCALE ACCORDINGLY

**IDAHO COUNTY**  
**IDAHO COUNTY AIRPORT (GIC)**  
 AIRPORT DATA SHEET

LAST UPDATED: 9/19/2022

SHEET NUMBER:

**AF-3**

"THE PREPARATION OF THESE DOCUMENTS WAS FINANCED IN PART THROUGH A PLANNING GRANT FROM THE FEDERAL AVIATION ADMINISTRATION AS PROVIDED UNDER SECTION 505 OF THE AIRPORT AND AIRWAY IMPROVEMENT ACT OF 1982, AS AMENDED. THE CONTENTS DO NOT NECESSARILY REFLECT THE OFFICIAL VIEWS OR POLICY OF THE FAA. ACCEPTANCE OF THESE DOCUMENTS BY THE FAA DOES NOT IN ANY WAY CONSTITUTE A COMMITMENT ON THE PART OF THE UNITED STATES TO PARTICIPATE IN ANY DEVELOPMENT DEPICTED HEREIN NOR DOES IT INDICATE THAT THE PROPOSED DEVELOPMENT IS ENVIRONMENTALLY ACCEPTABLE IN ACCORDANCE WITH APPROPRIATE PUBLIC LAWS."

Plot Date: 9/28/2022 7:16 AM Plotted By: Shawn Dulin  
 Date Created: 9/19/2022 \\JUB\COMMON\CLIENTS\ID\IDACO\COUNTY\PROJECTS\45-20-020\_AF-3.DWG

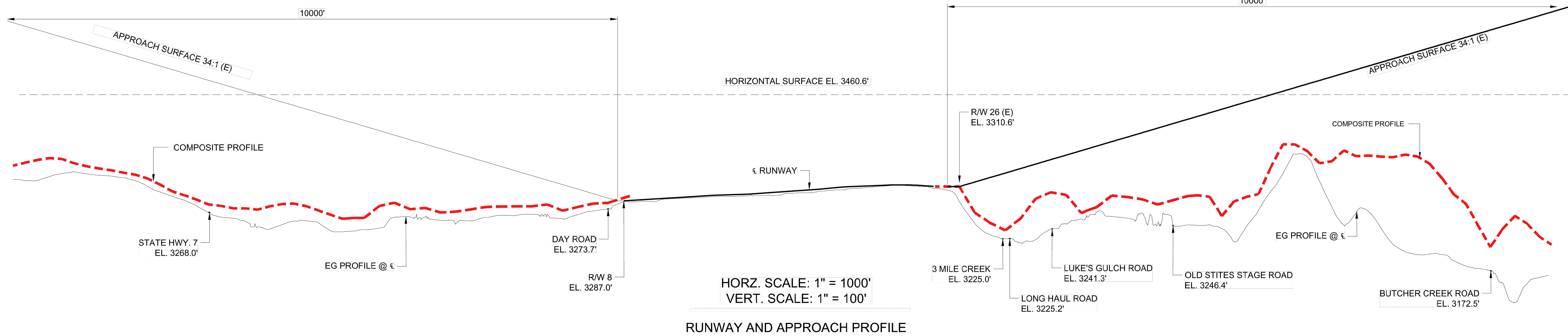

RUNWAY AND APPROACH PROFILE

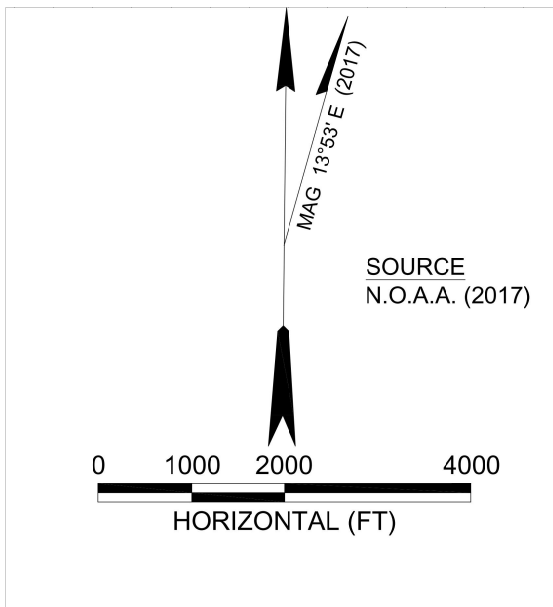

RUNWAY SURFACE OBSTRUCTION DATA					
NO.	ITEM	TOP ELEV	EXISTING/ULTIMATE		
			PART 77 SURFACE	OBSTRUCTION	OBSTRUCTION DISPOSITION
1	POLE	3298.1'	TRANSITIONAL SURFACE	26.7'	REMOVE POLE
2	POLE	3383.7'	TRANSITIONAL SURFACE	58.8'	REMOVE POLE

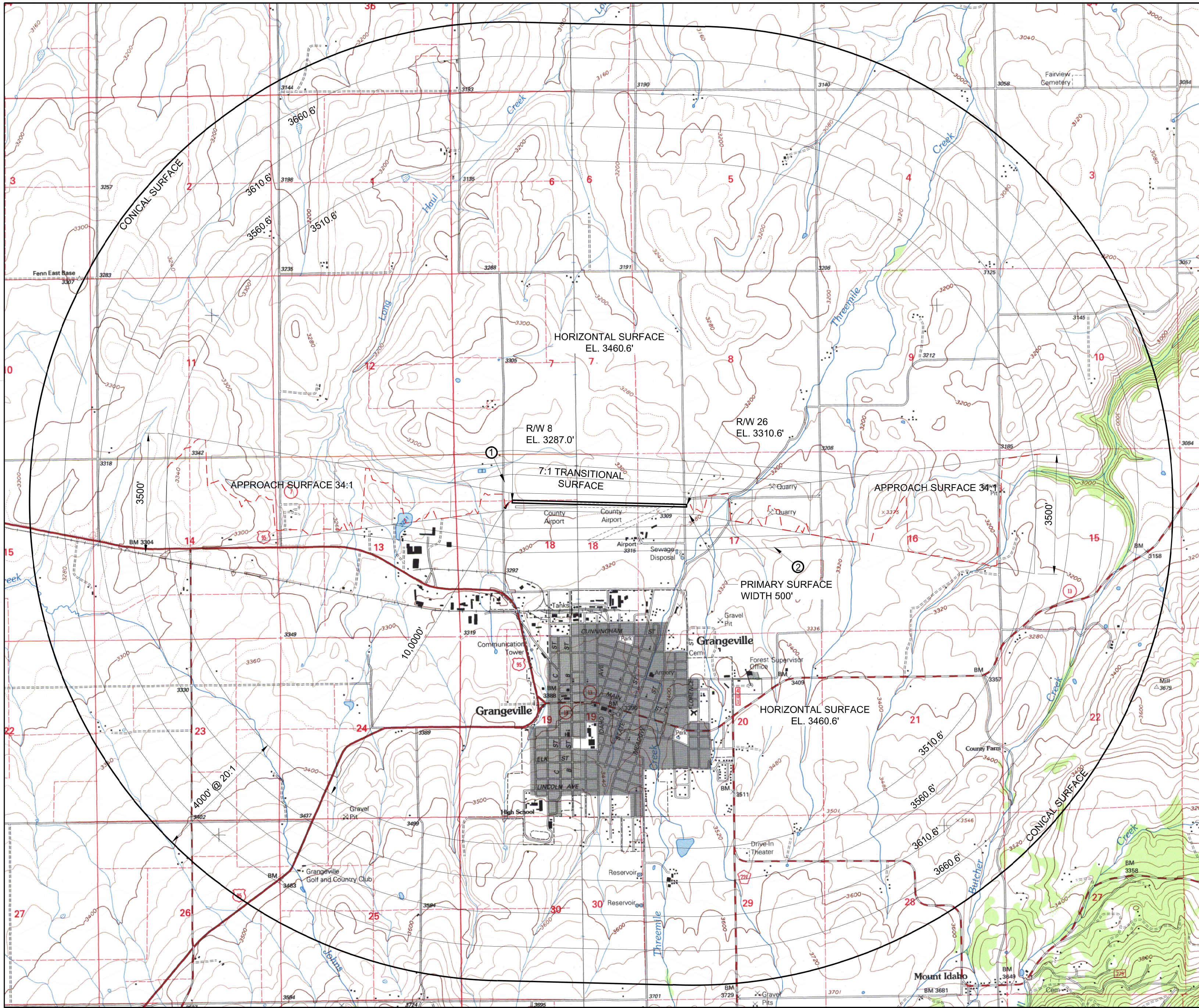

PLAN VIEW OF THE FAR PART 77 SUBPART C IMAGINARY SURFACE

77 Southway, Suite C  
 Lewiston, ID 83501  
 Phone: (208) 743-3818  
 Fax: (208) 743-3819

**RIEDEL**  
 Engineering

THIS DOCUMENT AND THE IDEAS AND DESIGNS INCORPORATED HEREIN, AS AN INSTRUMENT OF PROFESSIONAL SERVICES, ARE THE PROPERTY OF RIEDEL ENGINEERING, INC. NO PART OF THIS DOCUMENT OR PROJECT OR THE EXTENSION OF THIS PROJECT MAY BE REPRODUCED OR TRANSMITTED IN ANY FORM OR BY ANY MEANS, ELECTRONIC OR MECHANICAL, INCLUDING PHOTOCOPYING, RECORDING, OR BY ANY INFORMATION STORAGE AND RETRIEVAL SYSTEM, WITHOUT THE WRITTEN AUTHORIZATION OF RIEDEL ENGINEERING, INC.

NO.	DATE	BY	DESCRIPTION
1			
2			
3			
4			
5			
6			

IDAHO COUNTY AIRPORT  
 AIRPORT LAYOUT PLAN DRAWING SET  
 AIP 3-16-0015-015-2015  
 AIRPORT AIRSPACE PLAN

DESIGNED  
WDR  
 DESIGN CHECKED  
JRW  
 DETAILED  
WDR  
 DRAWING CHECKED  
KEB  
 FILE NAME  
2081-CLR.dwg  
 DRAWING DATE  
4/24/17  
 DRAWING SCALE  
AS SHOWN  
 SHEET 4 OF 6

"THE PREPARATION OF THESE DOCUMENTS WAS FINANCED IN PART THROUGH A PLANNING GRANT FROM THE FEDERAL AVIATION ADMINISTRATION AS PROVIDED UNDER SECTION 503 OF THE AIRPORT AND AIRWAY IMPROVEMENT ACT OF 1982, AS AMENDED. THE CONTENTS DO NOT NECESSARILY REFLECT THE OFFICIAL VIEWS OR POLICY OF THE FAA. ACCEPTANCE OF THESE DOCUMENTS BY THE FAA DOES NOT IN ANY WAY CONSTITUTE A COMMITMENT ON THE PART OF THE UNITED STATES TO PARTICIPATE IN ANY DEVELOPMENT DEPICTED HEREIN NOR DOES IT INDICATE THAT THE PROPOSED DEVELOPMENT IS ENVIRONMENTALLY ACCEPTABLE IN ACCORDANCE WITH APPROPRIATE PUBLIC LAWS."

REUSE OF DRAWINGS				
J-U-B SHALL RETAIN ALL COMMON LAW, STATUTORY, COPYRIGHT AND OTHER RESERVED RIGHTS OF THESE DRAWINGS, AND THE SAME SHALL NOT BE REUSED WITHOUT J-U-B'S PRIOR WRITTEN CONSENT. ANY REUSE WITHOUT WRITTEN CONSENT BY J-U-B WILL BE AT CLIENT'S SOLE RISK AND WITHOUT LIABILITY OR LEGAL EXPOSURE TO J-U-B.				
NO.	DESCRIPTION	FAA UPDATE APR.	DATE	



**J-U-B ENGINEERS, INC.**  
 846 6th Street  
 Clarkston, WA 99403  
 Phone: 509-254-6011  
 www.jub.com

FILE: 45-20-020\_AF-4  
 SUB PROJ: 45-20-020  
 DRAWN BY: SMD  
 DESIGN BY: SMD  
 CHECKED BY: TJE

ONE INCH  
 AT FULL SIZE, IF NOT ONE  
 INCH, SCALE ACCORDINGLY

IDAHO COUNTY  
 IDAHO COUNTY AIRPORT (GIC)

AIRPORT AIRSPACE PLAN

LAST UPDATED: 8/19/2022  
 SHEET NUMBER:  
**AF-4**

Plot Date: 8/19/2022 10:00 AM Plotted By: Bill Rowland  
 Date Created: 7/25/2022 \\JUB-COM\CENTRAL\CLIENTS\ID\IDAHOCOUNTY\PROJECTS\45-20-020\_AF-4.dwg

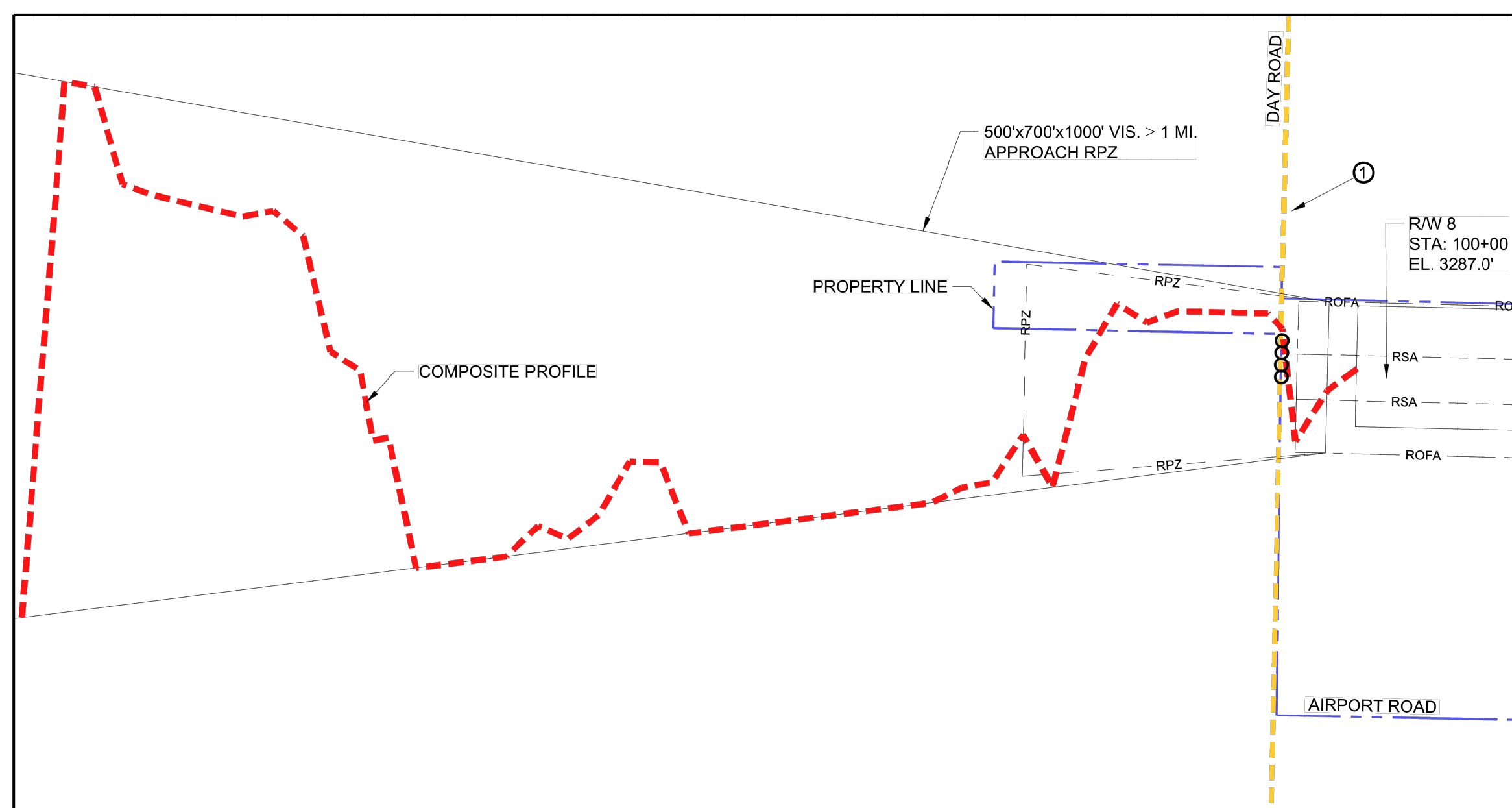

RUNWAY 8 PLAN  
SCALE: 1" = 400'

RUNWAY 8 SURFACE OBSTRUCTION DATA					
NO.	ITEM	TOP ELEV	EXISTING/ULTIMATE		
			PART 77 SURFACE	OBSTRUCTION	OBSTRUCTION DISPOSITION
1	POLE	3298.1'	TRANSITIONAL SURFACE	26.7'	REMOVE POLE

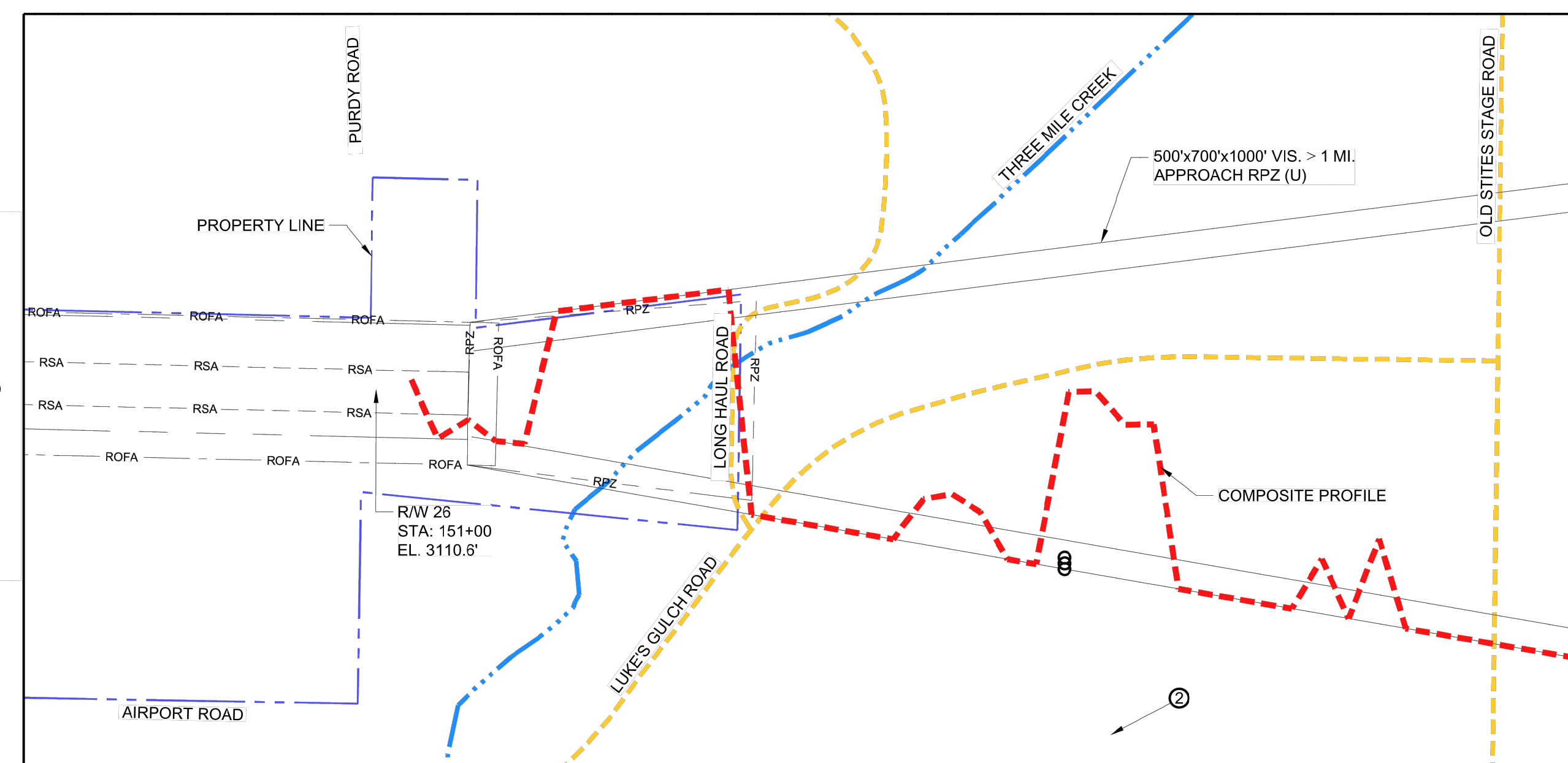
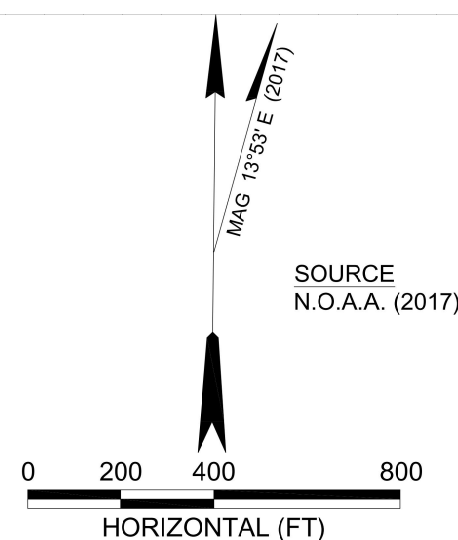

RUNWAY 26 PLAN  
SCALE: 1" = 400'

RUNWAY 26 SURFACE OBSTRUCTION DATA					
NO.	ITEM	TOP ELEV	EXISTING/ULTIMATE		
			PART 77 SURFACE	OBSTRUCTION	OBSTRUCTION DISPOSITION
2	POLE	3383.7'	TRANSITIONAL SURFACE	58.8	REMOVE POLE

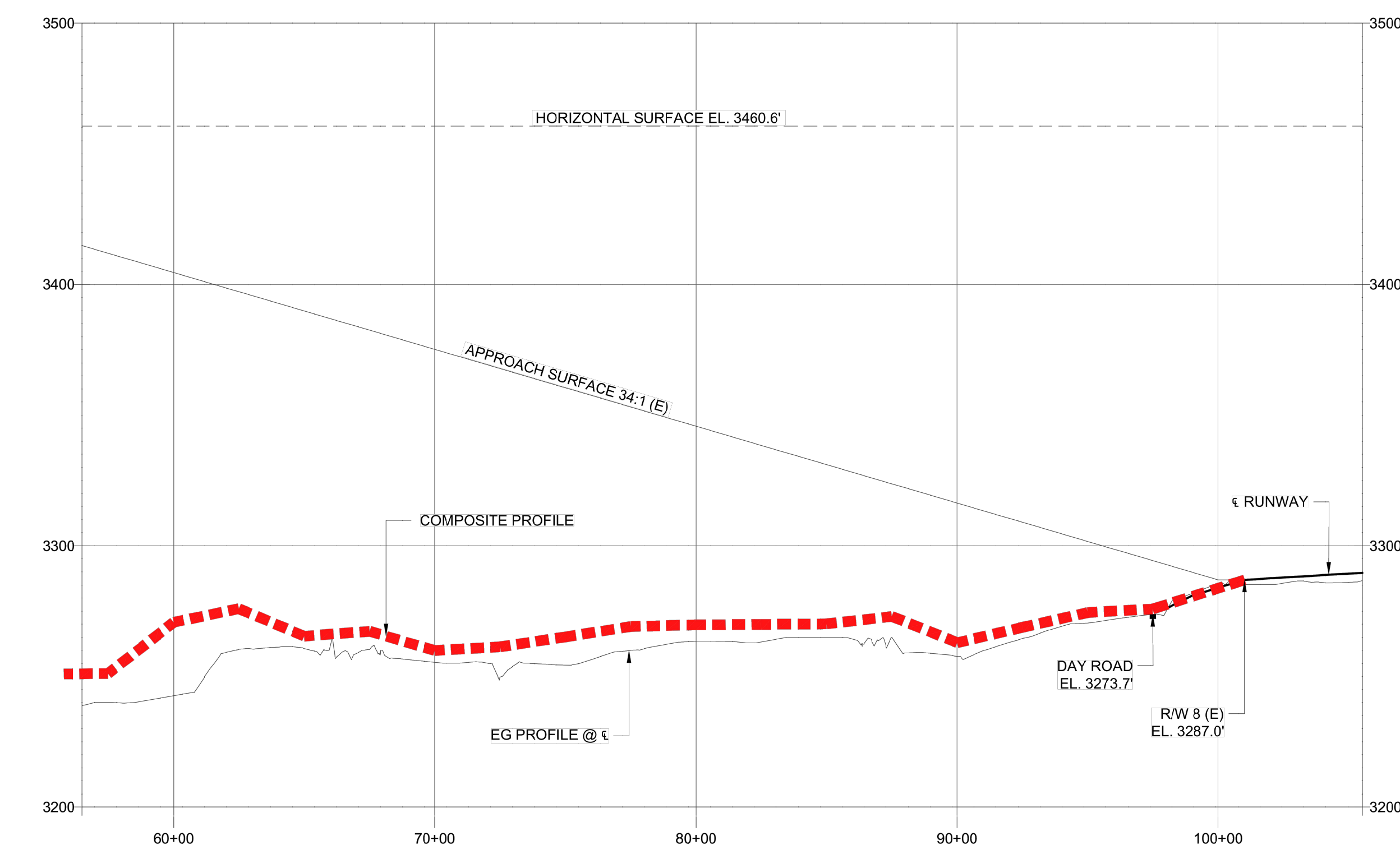

RUNWAY 8 PROFILE  
HORZ. SCALE: 1" = 400'  
VERT. SCALE: 1"=40'

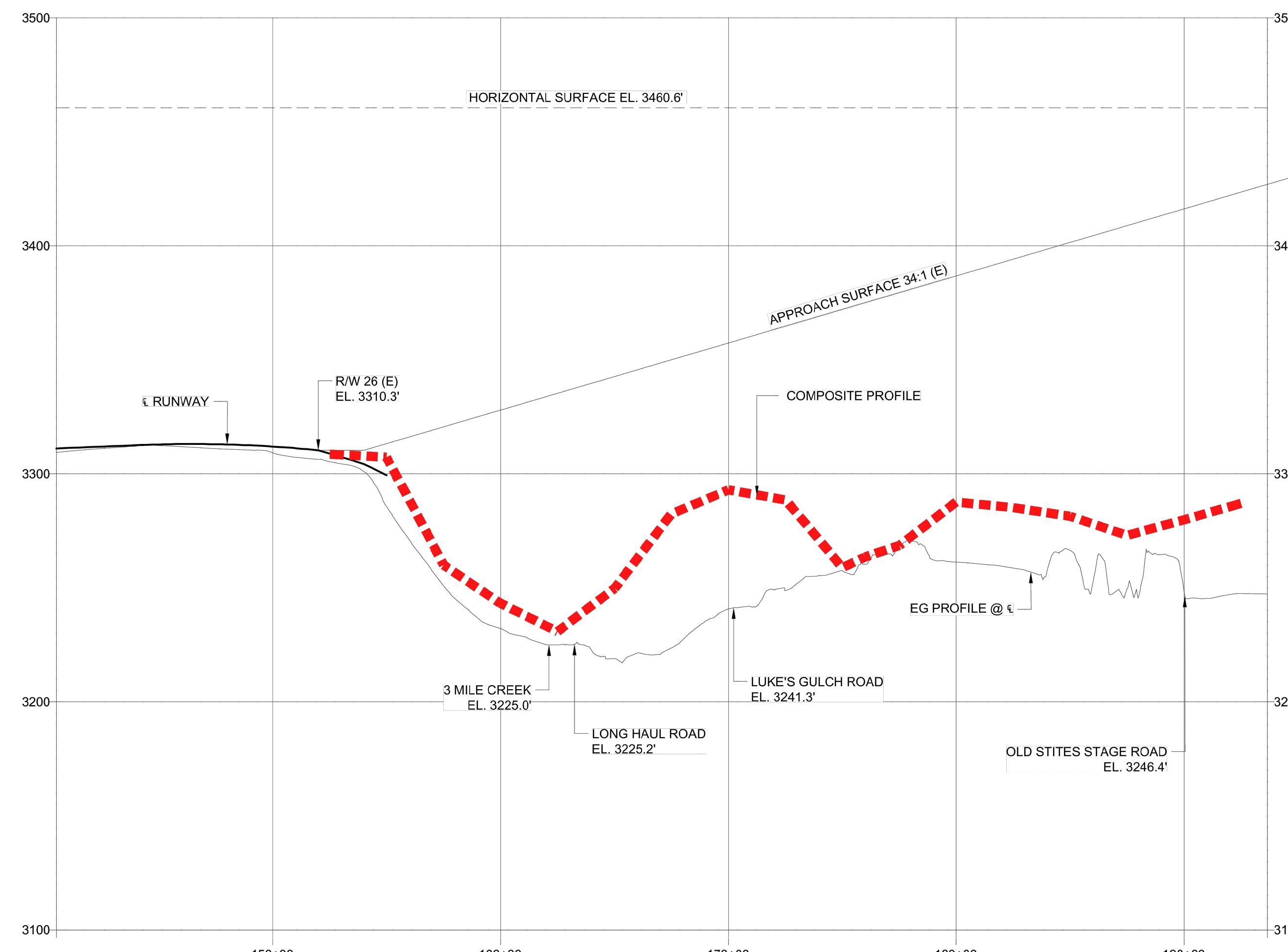

RUNWAY 26 PROFILE  
HORZ. SCALE: 1" = 400'  
VERT. SCALE: 1"=40'

77 Southway, Suite C  
Lewiston, Id. 83501  
Phone: (208) 743-3818  
Fax: (208) 743-3819

**RIEDEL**  
Engineering

THIS DOCUMENT AND THE IDEAS AND DESIGNS INCORPORATED HEREIN, AS AN INSTRUMENT OF PROFESSIONAL SERVICES, ARE THE PROPERTY OF RIEDEL ENGINEERING, INC. NO PART OF THIS DOCUMENT OR THE IDEAS AND DESIGNS INCORPORATED HEREIN, SHALL BE REPRODUCED OR TRANSMITTED IN ANY FORM OR BY ANY MEANS, ELECTRONIC OR MECHANICAL, INCLUDING PHOTOCOPYING, RECORDING, OR BY ANY INFORMATION STORAGE AND RETRIEVAL SYSTEM, WITHOUT THE WRITTEN AUTHORIZATION OF RIEDEL ENGINEERING, INC.

NO.	DATE	BY	DESCRIPTION
1			
2			
3			
4			
5			
6			

IDAHO COUNTY AIRPORT  
AIRPORT LAYOUT PLAN DRAWING SET  
AIP 3-16-0015-015-2015

R.P.Z. PLAN & PROFILE - RUNWAY 8/26

DESIGNED	WDR
DESIGN CHECKED	JRW
DETAILED	WDR
DRAWING CHECKED	KEB
FILE NAME	2061-CLR2.dwg
DRAWING DATE	4/24/17
DRAWING SCALE	AS SHOWN
SHEET	5 OF 6

THE PREPARATION OF THESE DOCUMENTS WAS FINANCED IN PART THROUGH A PLANNING GRANT FROM THE FEDERAL AVIATION ADMINISTRATION AS PROVIDED UNDER SECTION 503 OF THE AIRPORT AND AIRWAY IMPROVEMENT ACT OF 1982, AS AMENDED. THE CONTENTS DO NOT NECESSARILY REFLECT THE OFFICIAL VIEWS OR POLICY OF THE FAA. ACCEPTANCE OF THESE DOCUMENTS BY THE FAA DOES NOT IN ANY WAY CONSTITUTE A COMMITMENT ON THE PART OF THE UNITED STATES TO PARTICIPATE IN ANY DEVELOPMENT DEPICTED HEREIN NOR DOES IT INDICATE THAT THE PROPOSED DEVELOPMENT IS ENVIRONMENTALLY ACCEPTABLE IN ACCORDANCE WITH APPROPRIATE PUBLIC LAWS.

Plot Date: 9/28/2022 2:52 PM, Plotted By: Shawn Dulin, Date Created: 9/28/2022, \\JUB-COM-CENTRAL\CLIENTS\ID\IDACO\COUNTY\PROJECTS\45-20-020\_ALP\UPDATE\ENVIRONMENTAL\PLANNING\AIRPORT\MASTER\LAN\CAD\ALP\SHEETS\45-20-020\_AF-5.DWG

REVISION			
NO.	DESCRIPTION	FAA UPDATE	DATE



**JUB**  
J-U-B ENGINEERS, INC.

486 6th Street  
Clarkston, WA 99403  
Phone: 509-254-6011  
www.jub.com

FILE: 45-20-020\_AF-5  
JOB PROJ. #: 45-20-020  
DRAWN BY: SMD  
DESIGN BY: SMD  
CHECKED BY: TJE

ONE INCH  
AT FULL SIZE, IF NOT ONE  
INCH, SCALE ACCORDINGLY

IDAHO COUNTY  
IDAHO COUNTY AIRPORT (GIC)

INNER APPROACH DRAWING

LAST UPDATED: 9/28/2022  
SHEET NUMBER:  
**AF-5**

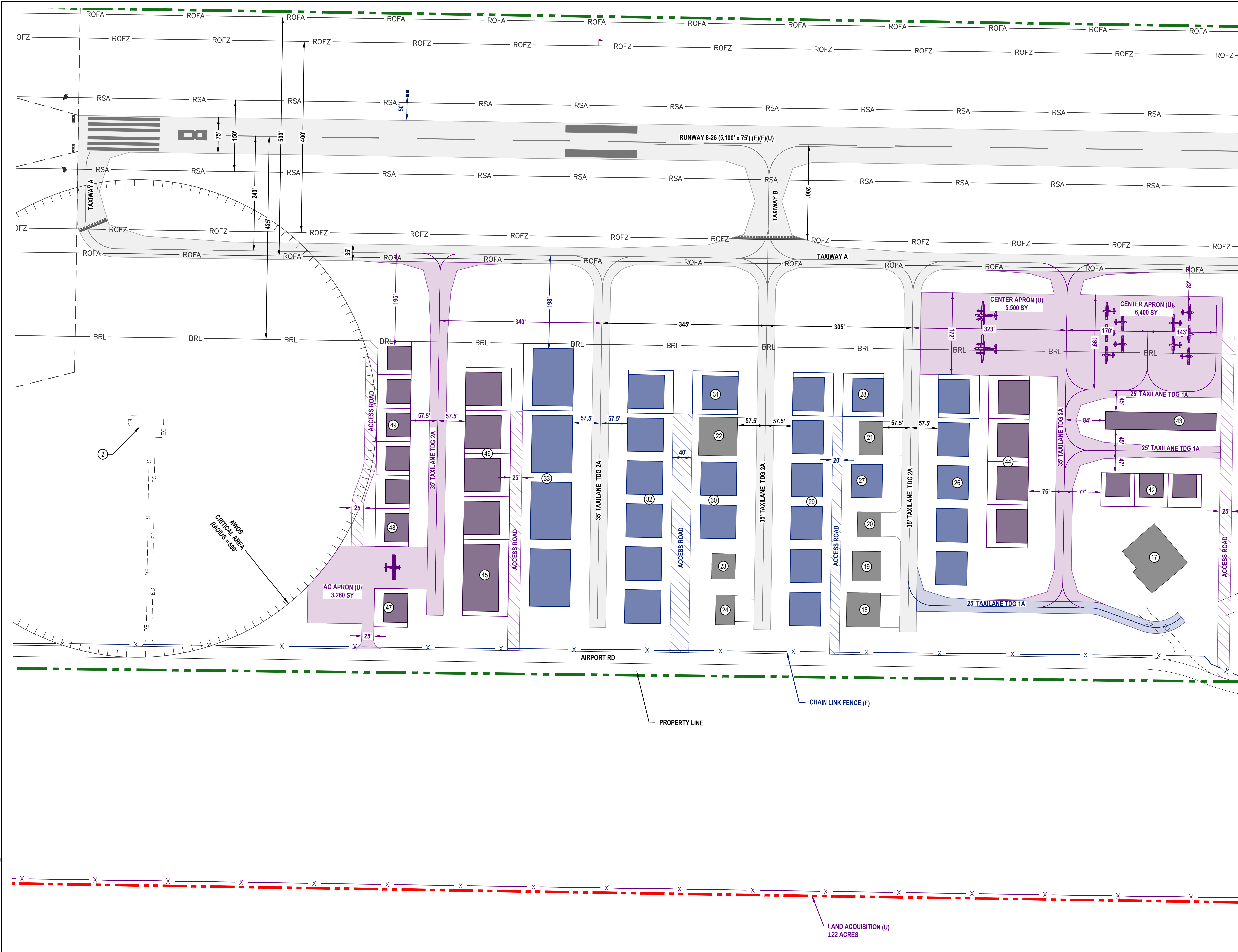

EXISTING BUILDING AND FACILITIES LIST					
NO.	DESCRIPTION	APPROXIMATE SIZE (SQ. FT.)	HEIGHT	TOP ELEV.	PART 77 PENETRATION
2	AWOS-3	N/A	36	3,322	NO
17	PRIVATE HANGAR	10,230	30	3,340	NO
18	PRIVATE HANGAR	5,025	20	3,325	NO
19	PRIVATE HANGAR	3,705	25	3,323	NO
20	PRIVATE HANGAR	2,615	25	3,326	NO
21	PRIVATE HANGAR	3,505	20	3,299	NO
22	PRIVATE HANGAR	6,490	25	3,318	NO
23	PRIVATE HANGAR	2,615	20	3,316	NO
24	PRIVATE HANGAR	2,465	20	3,317	NO

FUTURE LOT/BUILDING AND FACILITIES LIST				
NO.	DESCRIPTION	LOT DIMENSION	BUILDING HEIGHT	MAX TOP BUILDING ELEV.
25	BOX HANGAR (QTY 5)	85X90	20±	3,323
26	BOX HANGAR	85X90	20±	3,320
27	BOX HANGAR	85X90	20±	3,317
28	BOX HANGAR (QTY 6)	85X90	20±	3,323
29	BOX HANGAR (QTY 2)	90X95	20±	3,322
30	BOX HANGAR	90X95	20±	3,318
31	BOX HANGAR (QTY 6)	90X95	20±	3,317
32	BOX HANGAR (QTY 4)	105X140	20±	3,311

ULTIMATE LOT/BUILDING AND FACILITIES LIST				
NO.	DESCRIPTION	LOT DIMENSION	BUILDING HEIGHT	MAX TOP BUILDING ELEV.
33	BOX HANGAR (QTY 3)	70X70	20±	3,317
34	T-HANGAR	250X55	20±	3,306
35	BOX HANGAR (QTY 4)	85X90	20±	3,320
36	BOX HANGAR	160X95	20±	3,312
37	BOX HANGAR (QTY 4)	90X95	20±	3,307
38	BOX HANGAR	70X80	20±	3,306
39	BOX HANGAR	70X80	20±	3,305
40	BOX HANGAR (QTY 4)	70X70	20±	3,305

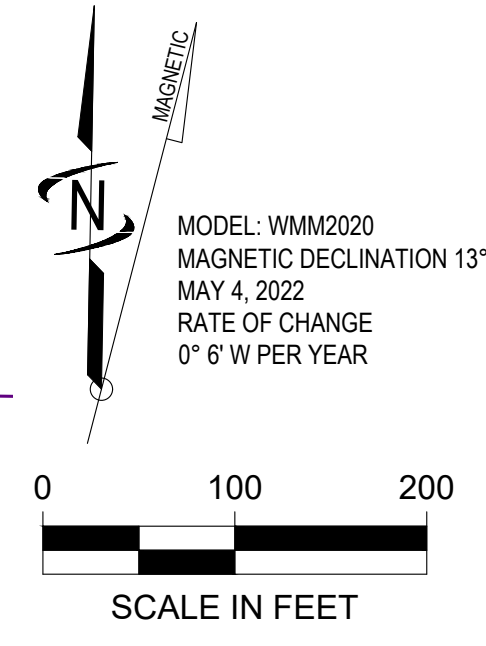

- NOTES:
- TRUE BEARINGS LISTED FOR RUNWAYS ARE GEODETIC VALUES. ELEVATIONS PUBLISHED ARE BASED ON NAD88 VERTICAL DATUM. HORIZONTAL DATUM IS NAD83/2011.
  - DATE OF OBSTRUCTION FLIGHT WAS N/A.
  - ALL FUTURE AND ULTIMATE TAXIWAY WIDTHS ARE 35' UNLESS SHOWN OTHERWISE.
  - TAXIWAY EDGE SAFETY MARGIN (TESM); TAXIWAY DESIGN GROUP (TDG) 2A (E); 7.5 FT, 1A (E); 5 FT.
  - TAXIWAY SHOULDER WIDTH; TAXIWAY DESIGN GROUP (TDG) 2A (E); 15 FT, 1A (E); 10 FT.
  - TAXIWAY OBJECT FREE AREA (TOFA); AIRPLANE DESIGN GROUP (ADG) II (E,F,U); 124 FT.
  - TAXIWAY OBJECT FREE AREA (TOFA); AIRPLANE DESIGN GROUP (ADG) II (E,F,U); 110 FT, (ADG) I (E,F,U); 79 FT.
  - TAXIWAY/TAXIWAY SAFETY AREA (TSA); AIRPLANE DESIGN GROUP (ADG) II (E,F,U); 79 FT, (ADG) I (E,F,U); 49 FT.
  - ALL FENCES ARE 6 FEET IN HEIGHT UNLESS OTHERWISE NOTED.
  - THE DEPICTED 25-FOOT BUILDING RESTRICTION LINE IS INTENDED AS A GUIDELINE ONLY. FUTURE HANGARS MUST RECEIVE A NO-HAZARD DETERMINATION VIA FAA FROM 7460 FILING.

LEGEND			
EXISTING (E)	FUTURE SHORT TERM (F)	ULTIMATE LONG TERM (U)	DESCRIPTION
[Symbol]	[Symbol]	[Symbol]	BUILDING/STRUCTURE
[Symbol]	[Symbol]	[Symbol]	AIRPORT PAVEMENT AND MARKINGS
[Symbol]	[Symbol]	[Symbol]	PAVEMENT TO BE REMOVED
[Symbol]	[Symbol]	[Symbol]	ROADWAY
[Symbol]	[Symbol]	[Symbol]	AIRPORT PROPERTY LINE
[Symbol]	[Symbol]	[Symbol]	AIRPORT PROPERTY EASEMENTS
[Symbol]	[Symbol]	[Symbol]	THRESHOLD SIGHTING SURFACE (TSS)
[Symbol]	[Symbol]	[Symbol]	PART 77 APPROACH SURFACE
[Symbol]	[Symbol]	[Symbol]	25 FOOT BUILDING RESTRICTION LINE (BRL)
[Symbol]	[Symbol]	[Symbol]	RUNWAY OBJECT FREE AREA (ROFA)
[Symbol]	[Symbol]	[Symbol]	RUNWAY PROTECTION ZONE (RPZ)
[Symbol]	[Symbol]	[Symbol]	RUNWAY SAFETY AREA (RSA)
[Symbol]	[Symbol]	[Symbol]	RUNWAY OBSTACLE FREE ZONE (ROFZ)
[Symbol]	[Symbol]	[Symbol]	TAXIWAY OBJECT FREE AREA (TOFA)
[Symbol]	[Symbol]	[Symbol]	NAVAID CRITICAL AREA
[Symbol]	[Symbol]	[Symbol]	FENCE
[Symbol]	[Symbol]	[Symbol]	THRESHOLD LIGHTS
[Symbol]	[Symbol]	[Symbol]	LANDING AID (PAPI-2)
[Symbol]	[Symbol]	[Symbol]	LANDING AID (REILS)
[Symbol]	[Symbol]	[Symbol]	SUPPLEMENTAL WINDCONE
[Symbol]	[Symbol]	[Symbol]	AIRPORT REFERENCE POINT (ARP)
[Symbol]	[Symbol]	[Symbol]	TREE

REUSE OF DRAWINGS

J-U-B SHALL RETAIN ALL COMMON LAW, STATUTORY, COPYRIGHT AND OTHER RESERVED RIGHTS OF THESE DRAWINGS, AND THE SAME SHALL NOT BE REUSED WITHOUT J-U-B'S PRIOR WRITTEN CONSENT. ANY REUSE WITHOUT WRITTEN CONSENT BY J-U-B WILL BE AT CLIENT'S SOLE RISK AND WITHOUT LIABILITY OR LEGAL EXPOSURE TO J-U-B.

NO.	DESCRIPTION	FAA UPDATE APR.	DATE

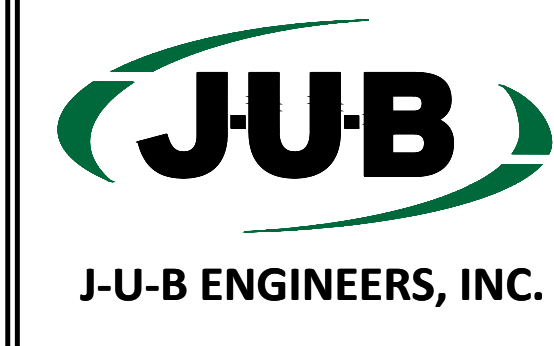

**J-U-B ENGINEERS, INC.**  
 846 6th Street  
 Clarkston, WA 99403  
 Phone: 509-254-6011  
 www.jub.com

FILE: 45-20-020-AF-6-7  
 JOB PROJ #: 45-20-020  
 DRAWN BY: SMD  
 DESIGN BY: SMD  
 CHECKED BY: TJE

ONE INCH  
 AT FULL SIZE, IF NOT ONE  
 INCH, SCALE ACCORDINGLY

IDAHO COUNTY  
 IDAHO COUNTY AIRPORT (GIC)  
 TERMINAL AREA PLAN - WEST AREA

LAST UPDATED: 9/7/2023  
 SHEET NUMBER:  
**AF-6**

"THE PREPARATION OF THESE DOCUMENTS WAS FINANCED IN PART THROUGH A PLANNING GRANT FROM THE FEDERAL AVIATION ADMINISTRATION AS PROVIDED UNDER SECTION 505 OF THE AIRPORT AND AIRWAY IMPROVEMENT ACT OF 1982, AS AMENDED. THE CONTENTS DO NOT NECESSARILY REFLECT THE OFFICIAL VIEWS OR POLICY OF THE FAA. ACCEPTANCE OF THESE DOCUMENTS BY THE FAA DOES NOT IN ANY WAY CONSTITUTE A COMMITMENT ON THE PART OF THE UNITED STATES TO PARTICIPATE IN ANY DEVELOPMENT DEPICTED HEREIN NOR DOES IT INDICATE THAT THE PROPOSED DEVELOPMENT IS ENVIRONMENTALLY ACCEPTABLE IN ACCORDANCE WITH APPROPRIATE PUBLIC LAWS."

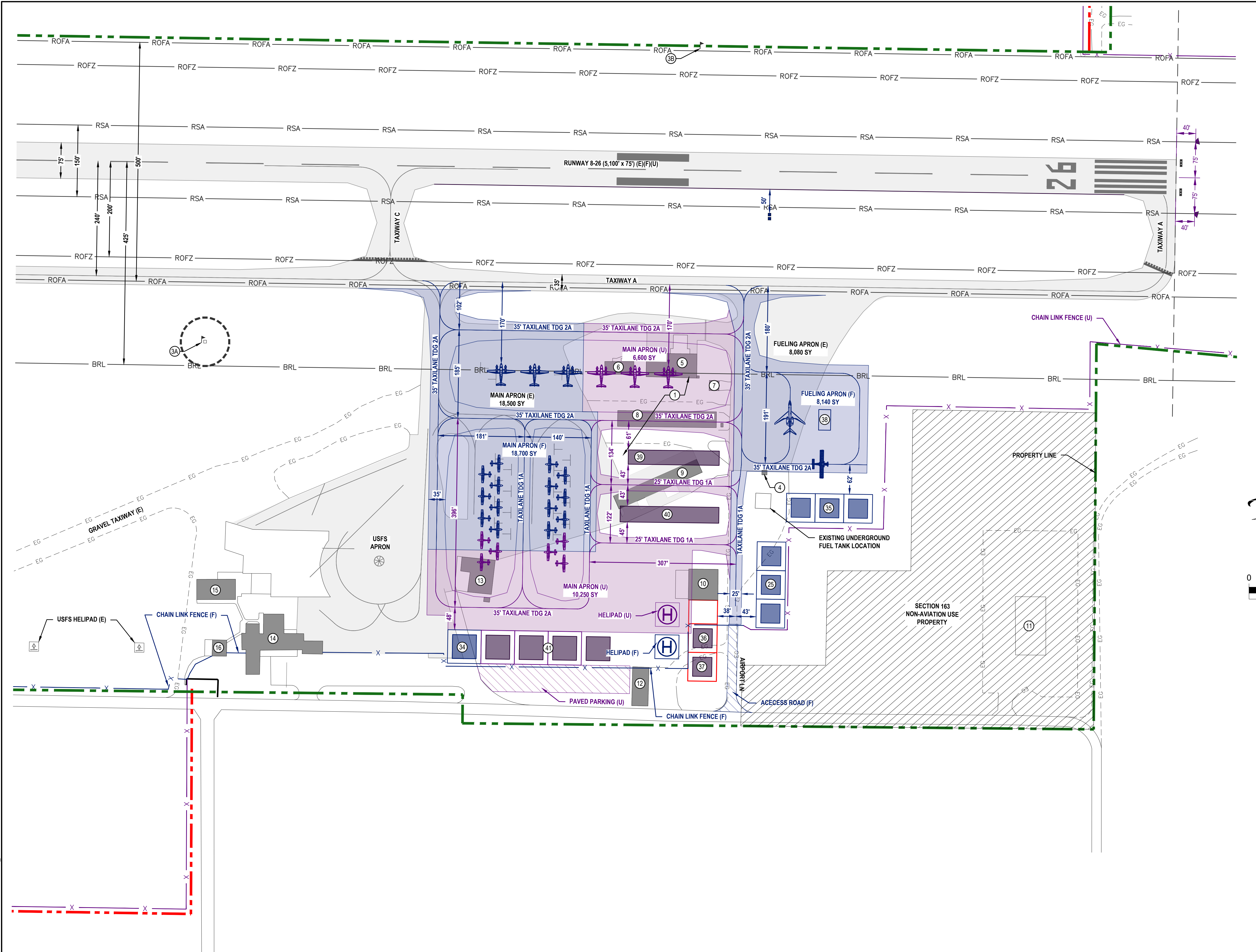

EXISTING BUILDING AND FACILITIES LIST					
NO.	DESCRIPTION	APPROXIMATE SIZE (SQ. FT.)	HEIGHT	TOP ELEV.	PART 77 PENETRATION
1	ROTATING BEACON (TO BE RELOCATED ON TIFDOWN POLE-ULTIMATE)	N/A	28	3,344	12'
2	SEGMENTED CIRCLE & LIGHTED WIND CONE	N/A	24	3,344	20'
3	LIGHTED WIND CONE	N/A	24	3,332	20'
4	FUELING FACILITY (AVGAS 100LL & JET A)	N/A	20	3,315	NO
5	PILOT LOUNGE & AIRPORT OFFICE/ PRIVATE HANGAR	5,265	22	3,336	5'
6	AIRPORT MAINTENANCE SUPERVISOR QUARTERS	1,625	15	3,329	NO
7	AIRPORT COURTESY CAR SHED	425	10	3,325	NO
8	PRIVATE T-HANGAR	6,855	20	3,335	NO
9	PRIVATE T-HANGAR (UNITS)	5,700	20	3,336	NO
10	PRIVATE HANGAR	3,975	25	3,315	NO
11	IDAHO COUNTY SHERIFF	7,765	26	3,311	NO
12	IDAHO COUNTY WEED DEPARTMENT	2,775	20	3,340	NO
13	PRIVATE HANGAR	4,170	25	3,342	NO
14	UNITED STATES FOREST SERVICE (U.S.F.S.)	9,425	30	3,344	NO
15	UNITED STATES FOREST SERVICE (U.S.F.S.)	3,460	35	3,351	NO
16	UNITED STATES FOREST SERVICE (U.S.F.S.)	1,015	15	3,331	NO

FUTURE LOT/BUILDING AND FACILITIES LIST				
NO.	DESCRIPTION	LOT DIMENSION	BUILDING HEIGHT	MAX TOP BUILDING ELEV.
27	BOX HANGAR (QTY 3)	60x60	20±	3,324
28	PILOT LOUNGE	70x70	20±	3,333
29	BOX HANGAR (QTY 3)	60x60	20±	3,337

ULTIMATE LOT/BUILDING AND FACILITIES LIST				
NO.	DESCRIPTION	LOT DIMENSION	BUILDING HEIGHT	MAX TOP BUILDING ELEV.
30	SITE MANAGER	60x60	20±	3,325
31	SNOW REMOVAL EQUIPMENT (SRE) BUILDING	60x60	20±	3,326
32	RELOCATED FUEL ISLAND	N/A	N/A	3,310
33	PRIVATE T-HANGAR	210x50	20±	3,327
34	PRIVATE T-HANGAR	225x50	20±	3,327
35	BOX HANGAR (QTY 4)	70x70	20±	3,333

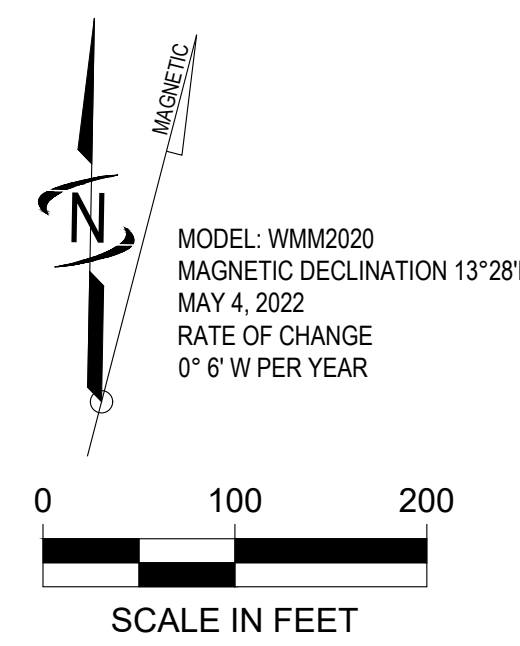

NOTES:  
 1. TRUE BEARINGS LISTED FOR RUNWAYS ARE GEODETIC VALUES. ELEVATIONS PUBLISHED ARE BASED ON NAD88 VERTICAL DATUM. HORIZONTAL DATUM IS NAD83/2011.  
 2. DATE OF OBSTRUCTION FLIGHT WAS N/A.  
 3. ALL FUTURE AND ULTIMATE TAXIWAY WIDTHS ARE 35' UNLESS SHOWN OTHERWISE.  
 4. TAXIWAY EDGE SAFETY MARGIN (TESM); TAXIWAY DESIGN GROUP (TDG) 2A (E); 7.5 FT, 1A (E); 5 FT  
 5. TAXIWAY SHOULDER WIDTH; TAXIWAY DESIGN GROUP (TDG) 2A (E); 15 FT, 1A (E); 10 FT  
 6. TAXIWAY OBJECT FREE AREA (TOFA); AIRPLANE DESIGN GROUP (ADG) II (E,F,U); 124 FT  
 7. TAXILANE OBJECT FREE AREA (TOFA); AIRPLANE DESIGN GROUP (ADG) II (E,F,U); 110 FT, (ADG) I (E,F,U); 79 FT  
 8. TAXIWAY/TAXILANE SAFETY AREA (TSA); AIRPLANE DESIGN GROUP (ADG) II (E,F,U); 79 FT, (ADG) I (E,F,U); 49 FT  
 9. ALL FENCES ARE 6 FEET IN HEIGHT UNLESS OTHERWISE NOTED.  
 10. THE DEPICTED 25-FOOT BUILDING RESTRICTION LINE IS INTENDED AS A GUIDELINE ONLY. FUTURE HANGARS MUST RECEIVE A NO-HAZARD DETERMINATION VIA FAA FROM 7460 FLING.

LEGEND			
EXISTING (E)	FUTURE SHORT TERM (F)	ULTIMATE LONG TERM (U)	DESCRIPTION
[Symbol]	[Symbol]	[Symbol]	BUILDING/STRUCTURE
[Symbol]	[Symbol]	[Symbol]	AIRPORT PAVEMENT AND MARKINGS
[Symbol]	[Symbol]	[Symbol]	PAVEMENT TO BE REMOVED
[Symbol]	[Symbol]	[Symbol]	ROADWAY
[Symbol]	[Symbol]	[Symbol]	AIRPORT PROPERTY LINE
[Symbol]	[Symbol]	[Symbol]	AIRPORT PROPERTY EASEMENTS
[Symbol]	[Symbol]	[Symbol]	THRESHOLD SIGHTING SURFACE (TSS)
[Symbol]	[Symbol]	[Symbol]	PART 77 APPROACH SURFACE
[Symbol]	[Symbol]	[Symbol]	25 FOOT BUILDING RESTRICTION LINE (BRL)
[Symbol]	[Symbol]	[Symbol]	RUNWAY OBJECT FREE AREA (ROFA)
[Symbol]	[Symbol]	[Symbol]	RUNWAY PROTECTION ZONE (RPZ)
[Symbol]	[Symbol]	[Symbol]	RUNWAY SAFETY AREA (RSA)
[Symbol]	[Symbol]	[Symbol]	RUNWAY OBSTACLE FREE ZONE (ROFZ)
[Symbol]	[Symbol]	[Symbol]	TAXIWAY OBJECT FREE AREA (TOFA)
[Symbol]	[Symbol]	[Symbol]	NAVAID CRITICAL AREA
[Symbol]	[Symbol]	[Symbol]	FENCE
[Symbol]	[Symbol]	[Symbol]	THRESHOLD LIGHTS
[Symbol]	[Symbol]	[Symbol]	LANDING AID (PAPI-Z)
[Symbol]	[Symbol]	[Symbol]	LANDING AID (REILS)
[Symbol]	[Symbol]	[Symbol]	SUPPLEMENTAL WINDCONE
[Symbol]	[Symbol]	[Symbol]	AIRPORT REFERENCE POINT (ARP)
[Symbol]	[Symbol]	[Symbol]	TREE

REVISION			
NO.	DESCRIPTION	FAA UPDATE	DATE

Plot Date: 9/13/2023 12:20 PM Plotted By: Bill Rowland  
 Date Created: 9/7/2023 J:\LIB\COMM\CENTRAL\CLIENTS\ID\IDAHOCOUNTY\PROJECTS\45-20-020\ALP\UPDATE\ENVIRONMENTAL\PLANNING\AIRPORTMASTER\LAND\ALP\SHEETS\45-20-020-AF-6-7.DWG

REUSE OF DRAWINGS  
 J-U-B SHALL RETAIN ALL COMMON LAW, STATUTORY, COPYRIGHT AND OTHER RESERVED RIGHTS OF THESE DRAWINGS, AND THE SAME SHALL NOT BE REUSED WITHOUT J-U-B'S PRIOR WRITTEN CONSENT. ANY REUSE WITHOUT WRITTEN CONSENT BY J-U-B WILL BE AT CLIENT'S SOLE RISK AND WITHOUT LIABILITY OR LEGAL EXPOSURE TO J-U-B.

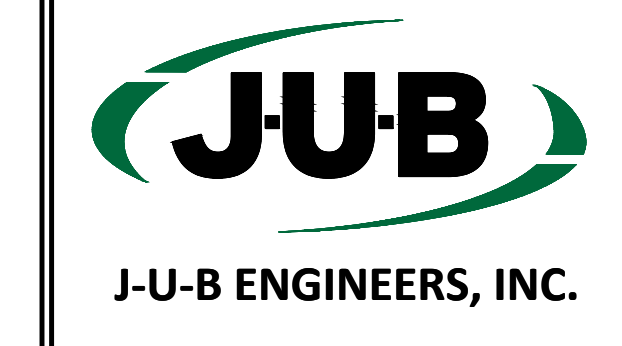

J-U-B ENGINEERS, INC.  
 846 6th Street  
 Clarkston, WA 99403  
 Phone: 509-254-6011  
 www.jub.com

FILE: 45-20-020-AF-6-7  
 JUB PROJ. #: 45-20-020  
 DRAWN BY: SMD  
 DESIGN BY: SMD  
 CHECKED BY: TJE  
 ONE INCH AT FULL SIZE, IF NOT ONE INCH, SCALE ACCORDINGLY

IDAHO COUNTY  
 IDAHO COUNTY AIRPORT (GIC)  
 TERMINAL AREA PLAN - EAST AREA

THE PREPARATION OF THESE DOCUMENTS WAS FINANCED IN PART THROUGH A PLANNING GRANT FROM THE FEDERAL AVIATION ADMINISTRATION AS PROVIDED UNDER SECTION 505 OF THE AIRPORT AND AIRWAY IMPROVEMENT ACT OF 1982, AS AMENDED. THE CONTENTS DO NOT NECESSARILY REFLECT THE OFFICIAL VIEWS OR POLICY OF THE FAA. ACCEPTANCE OF THESE DOCUMENTS BY THE FAA DOES NOT IN ANY WAY CONSTITUTE A COMMITMENT ON THE PART OF THE UNITED STATES TO PARTICIPATE IN ANY DEVELOPMENT DEPICTED HEREIN NOR DOES IT INDICATE THAT THE PROPOSED DEVELOPMENT IS ENVIRONMENTALLY ACCEPTABLE IN ACCORDANCE WITH APPROPRIATE PUBLIC LAWS.  
 LAST UPDATED: 9/12/2023  
 SHEET NUMBER:  
**AF-7**

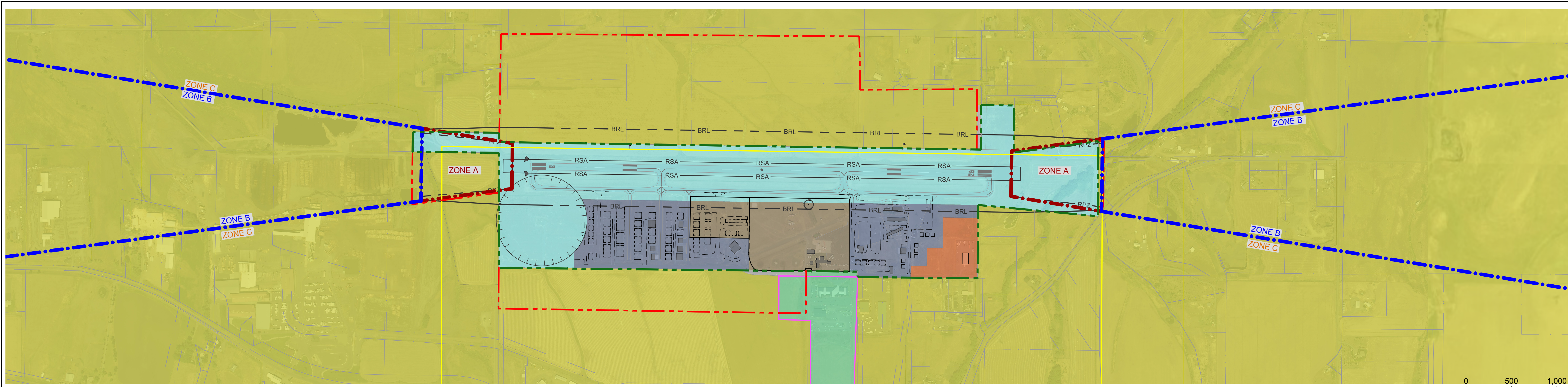

AIRPORT PLAN VIEW

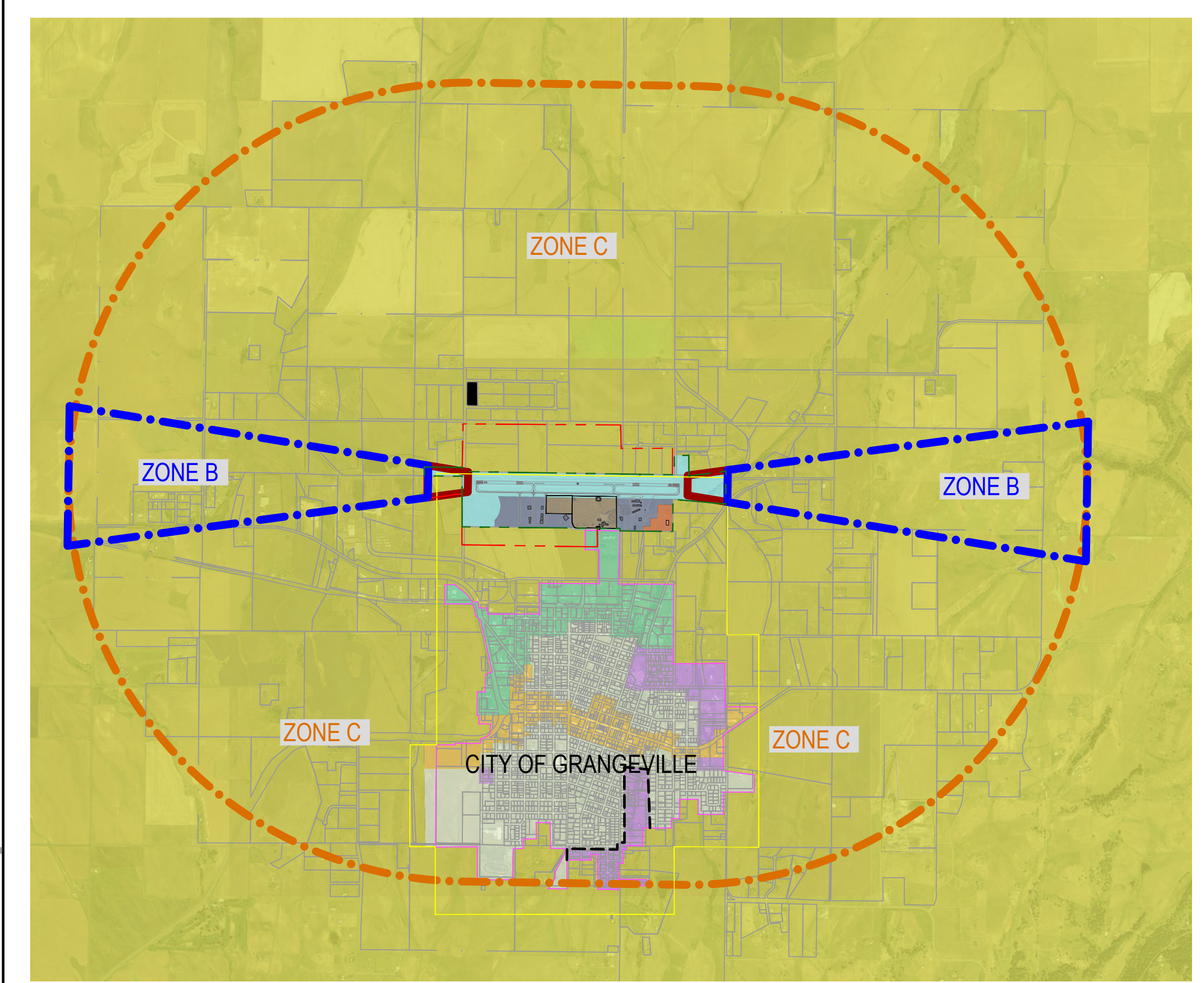
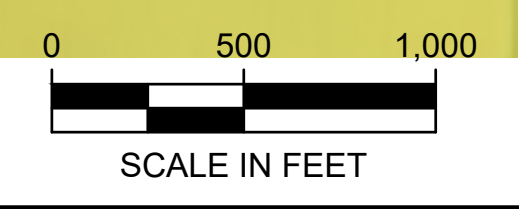

LARGE SCALE PLAN VIEW

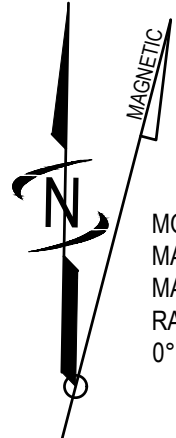
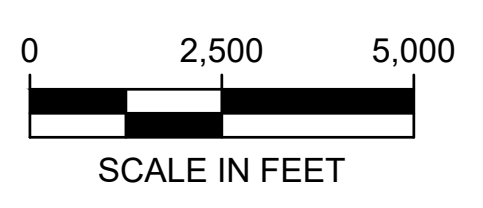

MODEL: WMM2020  
MAGNETIC DECLINATION 13°28'E  
MAY 4, 2022  
RATE OF CHANGE  
0° 6' W PER YEAR

CITY/COUNTY LAND USE	
[Light Green]	CITY - RESIDENTIAL A
[Light Blue]	CITY - RESIDENTIAL B
[Light Yellow]	CITY - INDUSTRIAL
[Light Orange]	CITY - COMMERCIAL
[Light Purple]	COUNTY - MIXED USE

AIRPORT LAND USE	
[Light Blue]	AIRFIELD OPERATIONS
[Light Green]	GENERAL AVIATION ZONE
[Light Yellow]	US FOREST SERVICE
[Light Orange]	NON-AVIATION

IDAHO COUNTY AIRPORT SAFETY ZONES	
[Red dashed line]	SAFETY ZONE A
[Blue dashed line]	SAFETY ZONE B
[Orange dashed line]	SAFETY ZONE C

NOTE:  
1. AIRPORT SAFETY ZONES SHOWN AS DEFINED IN THE IDAHO COUNTY AIRPORT ZONING ORDINANCE NO. 19 (AMENDED FEBRUARY 14, 2012).

LEGEND		
EXISTING	FUTURE/ULTIMATE	DESCRIPTION
[Solid black]	[Dashed black]	BUILDING/STRUCTURE
[Solid grey]	[Dashed grey]	AIRPORT PAVEMENT
[Green dashed line]	[Red dashed line]	AIRPORT PROPERTY LINE
[Thin grey line]	[Thin grey line]	PARCEL LINES
[Thin purple line]	[Thin purple line]	CITY LIMITS
[Thin yellow line]	[Thin yellow line]	CITY IMPACT BOUNDARY
[Thin blue line]	[Thin blue line]	25 FOOT BUILDING RESTRICTION LINE (BRL)
[Thin green line]	[Thin green line]	RUNWAY SAFETY AREA (RSA)
[Thin orange line]	[Thin orange line]	RUNWAY PROTECTION ZONE (RPZ)
[Thin black line]	[Thin black line]	NAVAID CRITICAL AREA

"THE PREPARATION OF THESE DOCUMENTS WAS FINANCED IN PART THROUGH A PLANNING GRANT FROM THE FEDERAL AVIATION ADMINISTRATION AS PROVIDED UNDER SECTION 505 OF THE AIRPORT AND AIRWAY IMPROVEMENT ACT OF 1982, AS AMENDED. THE CONTENTS DO NOT NECESSARILY REFLECT THE OFFICIAL VIEWS OR POLICY OF THE FAA. ACCEPTANCE OF THESE DOCUMENTS BY THE FAA DOES NOT IN ANY WAY CONSTITUTE A COMMITMENT ON THE PART OF THE UNITED STATES TO PARTICIPATE IN ANY DEVELOPMENT DEPICTED HEREIN NOR DOES IT INDICATE THAT THE PROPOSED DEVELOPMENT IS ENVIRONMENTALLY ACCEPTABLE IN ACCORDANCE WITH APPROPRIATE PUBLIC LAWS."

Plot Date: 9/28/2022 7:18 AM Plotted By: Shawn Dulin  
J:\LIB\COM\CENTRAL\CLIENTS\ID\IDAHO\COUNTY\PROJECTS\45-20-020\_ALP\UPDATE\ENVIRONMENTAL\PLANNING\AIRPORT\MASTER\LAN\CAD\ALP\SHEETS\45-20-020\_AF-8.DWG

REUSE OF DRAWINGS			
J-U-B SHALL RETAIN ALL COMMON LAW, STATUTORY, COPYRIGHT AND OTHER RESERVED RIGHTS OF THESE DRAWINGS, AND THE SAME SHALL NOT BE REUSED WITHOUT J-U-B'S PRIOR WRITTEN CONSENT. ANY REUSE WITHOUT WRITTEN CONSENT BY J-U-B WILL BE AT CLIENT'S SOLE RISK AND WITHOUT LIABILITY OR LEGAL EXPOSURE TO J-U-B.			
NO.	FAA COMMENTS	DESCRIPTION	FAA UPDATE APR. DATE



**J-U-B ENGINEERS, INC.**  
846 6th Street  
Clarkston, WA 99403  
Phone: 509-254-6011  
www.jub.com

FILE: 45-20-020-AP-8  
JOB PROJ. #: 45-20-020  
DRAWN BY: SMD  
DESIGN BY: SMD  
CHECKED BY: TJE

ONE INCH  
AT FULL SIZE, IF NOT ONE  
INCH, SCALE ACCORDINGLY

IDAHO COUNTY  
IDAHO COUNTY AIRPORT (GIC)

LAND USE PLAN

LAST UPDATED: 9/19/2022  
SHEET NUMBER:  
**AF-8**



